

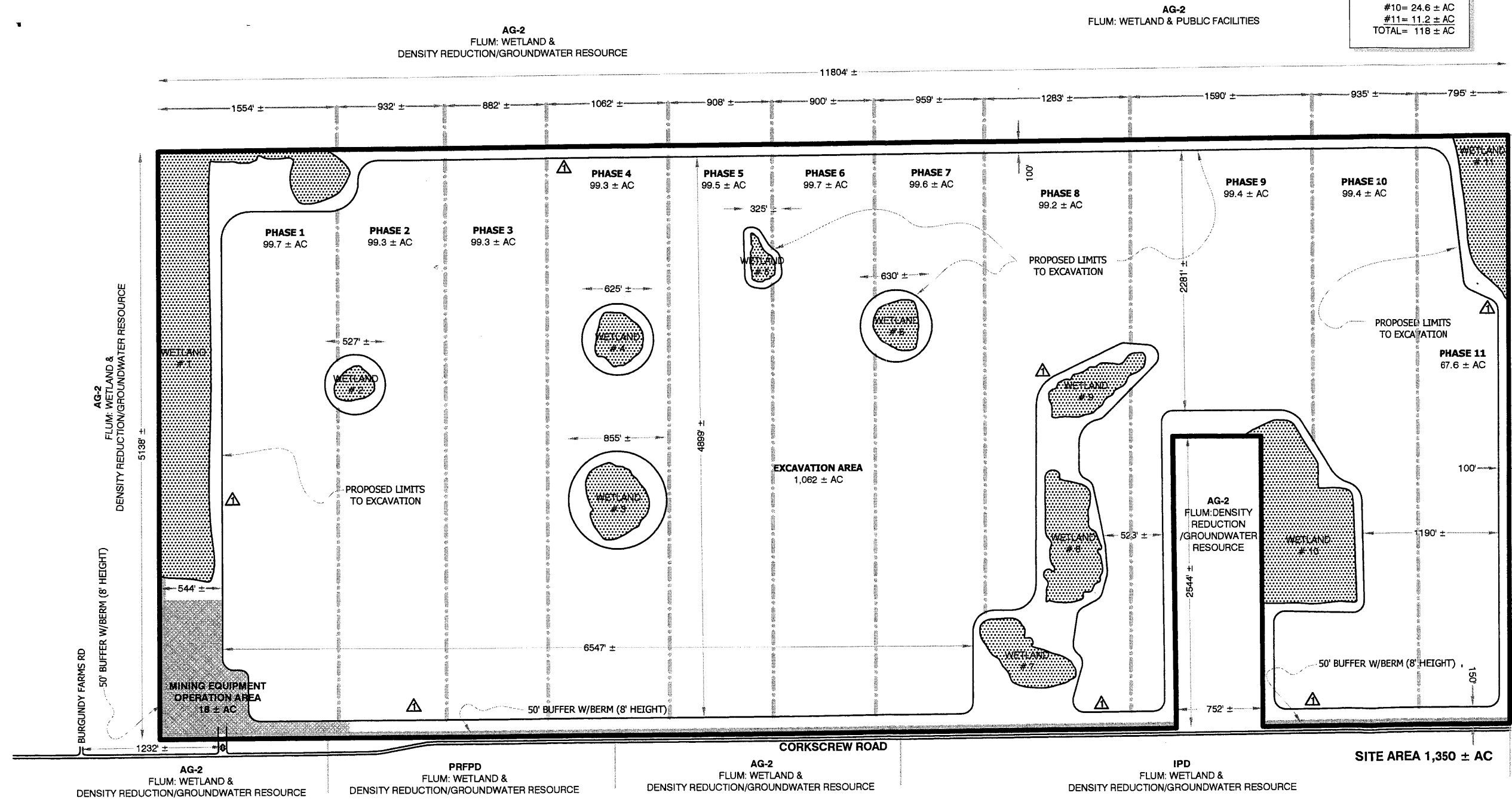

0 1000'
SCALE: 1" = 1000'

| WETLANDS AREA | |
|---------------|-----------------|
| #1= | 44.1 ± AC |
| #2= | 1.8 ± AC |
| #3= | 6.2 ± AC |
| #4= | 3.4 ± AC |
| #5= | 1.4 ± AC |
| #6= | 3.2 ± AC |
| #7= | 6.5 ± AC |
| #8= | 10.1 ± AC |
| #9= | 5.5 ± AC |
| #10= | 24.6 ± AC |
| #11= | 11.2 ± AC |
| TOTAL= | 118 ± AC |



REVISIONS

PHASING PLAN

CORKSCREW ROAD EXCAVATION
Section 23, 24, T-14c-5, R-24c-1 & Section 19, T-14c-5, R27-E, Lee County, Florida

MORRIS - DEPEW ASSOCIATES, INC.
ENGINEERS • PLANNERS • SURVEYORS & MAPPERS
225 Alhambra Avenue • Fort Myers, Florida 33901 • (813) 337-3993 • (813) 337-3994



| | |
|-----------------------|--------------------|
| MDA PROJECT: 05161 | |
| CHECKED BY: DWF | DESIGNED BY: AZ |
| DATE: 3/2/06 | |
| SHEET 1 | |